



East Stadium Bridges
Replacement Project – 2011
March 23, 2011
Public Information Meeting

the project

The replacement of the East Stadium bridges over South State Street and the Ann Arbor Railroad



East Stadium Bridges Replacement

tonight's agenda

6:30 – 6:45 Sign in

6:45 – 7:15 Status report

7:15 – 7:45 Informal Q&A

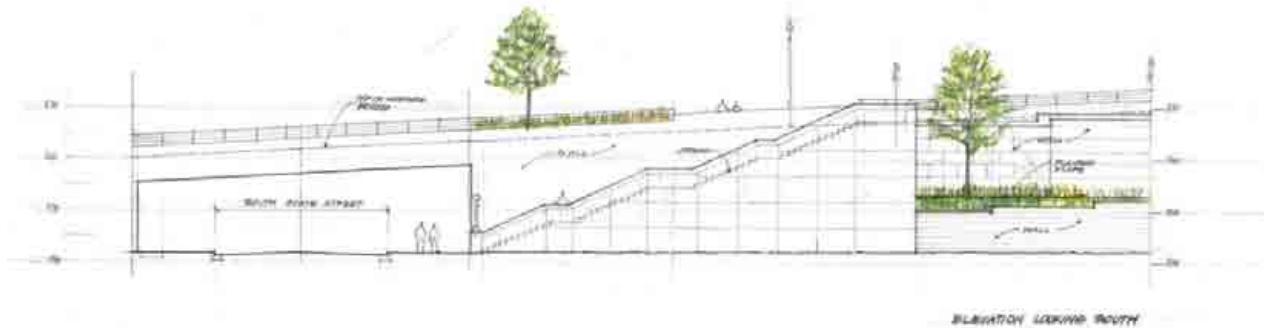

East Stadium Bridges Replacement

status report

Project history

- Project limits
- Project “givens”
- Design options

Final Design

- Construction plans/details
- Construction costs and funding
- Construction schedule + operations



Photo courtesy www.a2gov.org



project history – project limits



East Stadium Bridges Replacement

project history – project “givens”

DESIGN FOR THE NEXT 75 YEARS!

- Meet required vertical and horizontal clearances
- Adjust State Street elevation and re-pave
- Build retaining walls
- Add bike lanes
- Add sidewalks (ADA accessible)
 - South side of bridge
 - West side of S. State Street
- **Create pedestrian connections**
 - Stairways at NE and SW “corners”
 - ADA accessible route (State to E. Stadium)



- **Rose Avenue/
White Street**

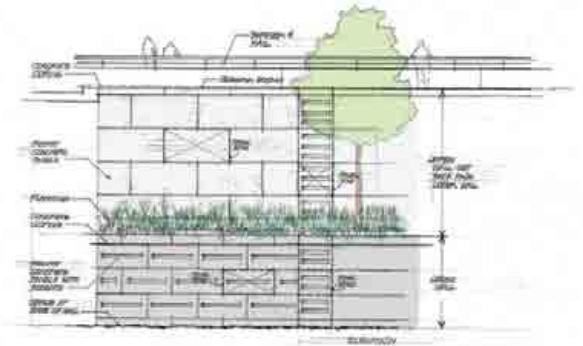
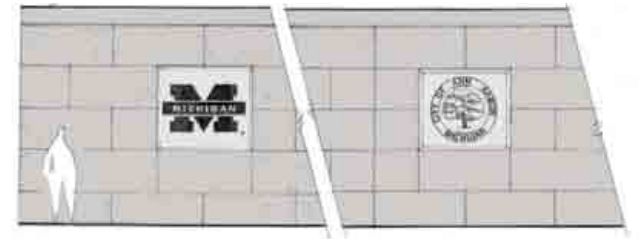

the plan

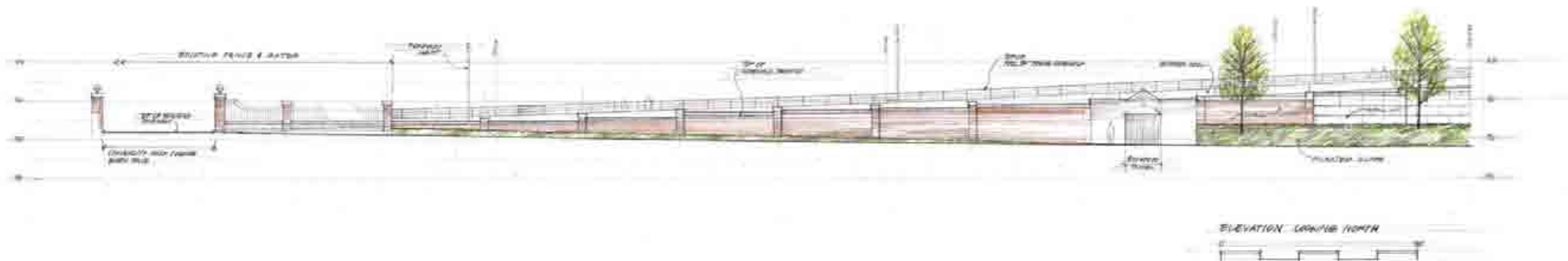
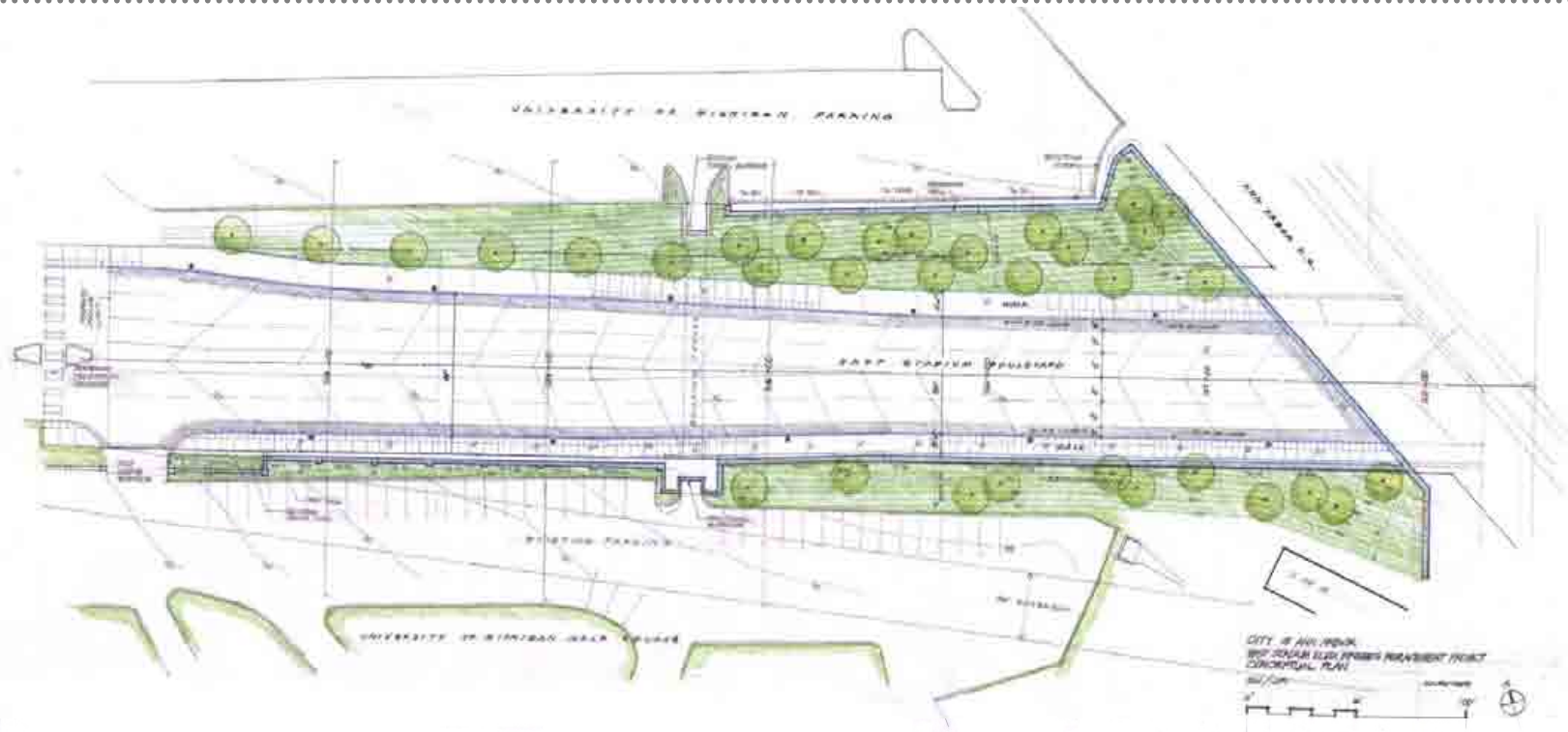
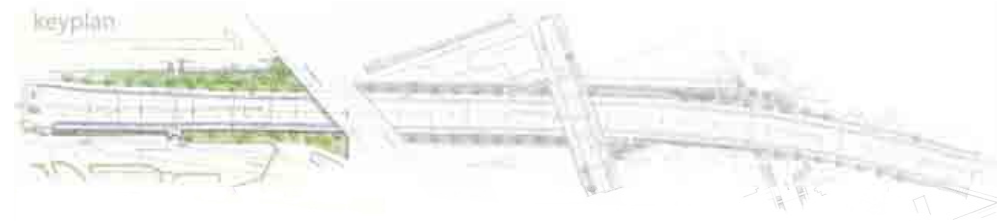

East Stadium Bridges Replacement

the plan

keyplan

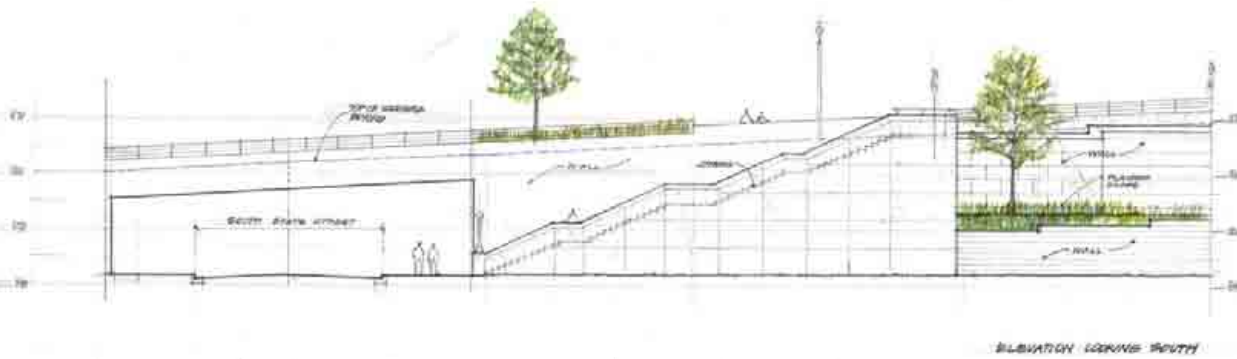
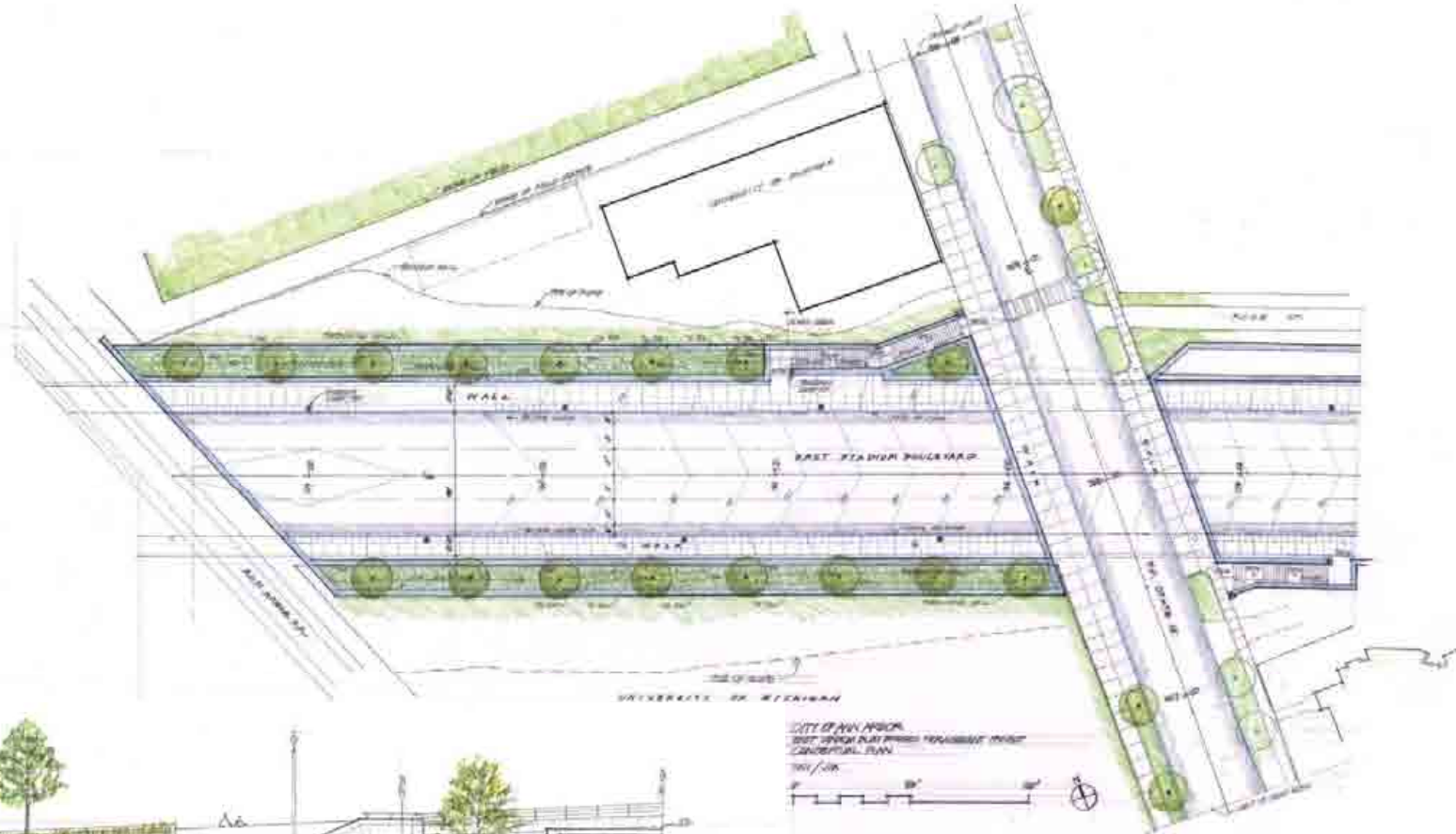

ELEVATION LOOKING SOUTH



East Stadium Bridges Replacement

the plan

keyplan



CITY OF ANN ARBOR
BAY BRIDGE EAST STADIUM BRIDGE REPLACEMENT PROJECT
CONCEPTUAL PLAN
04/1/15



East Stadium Bridges Replacement

typical section

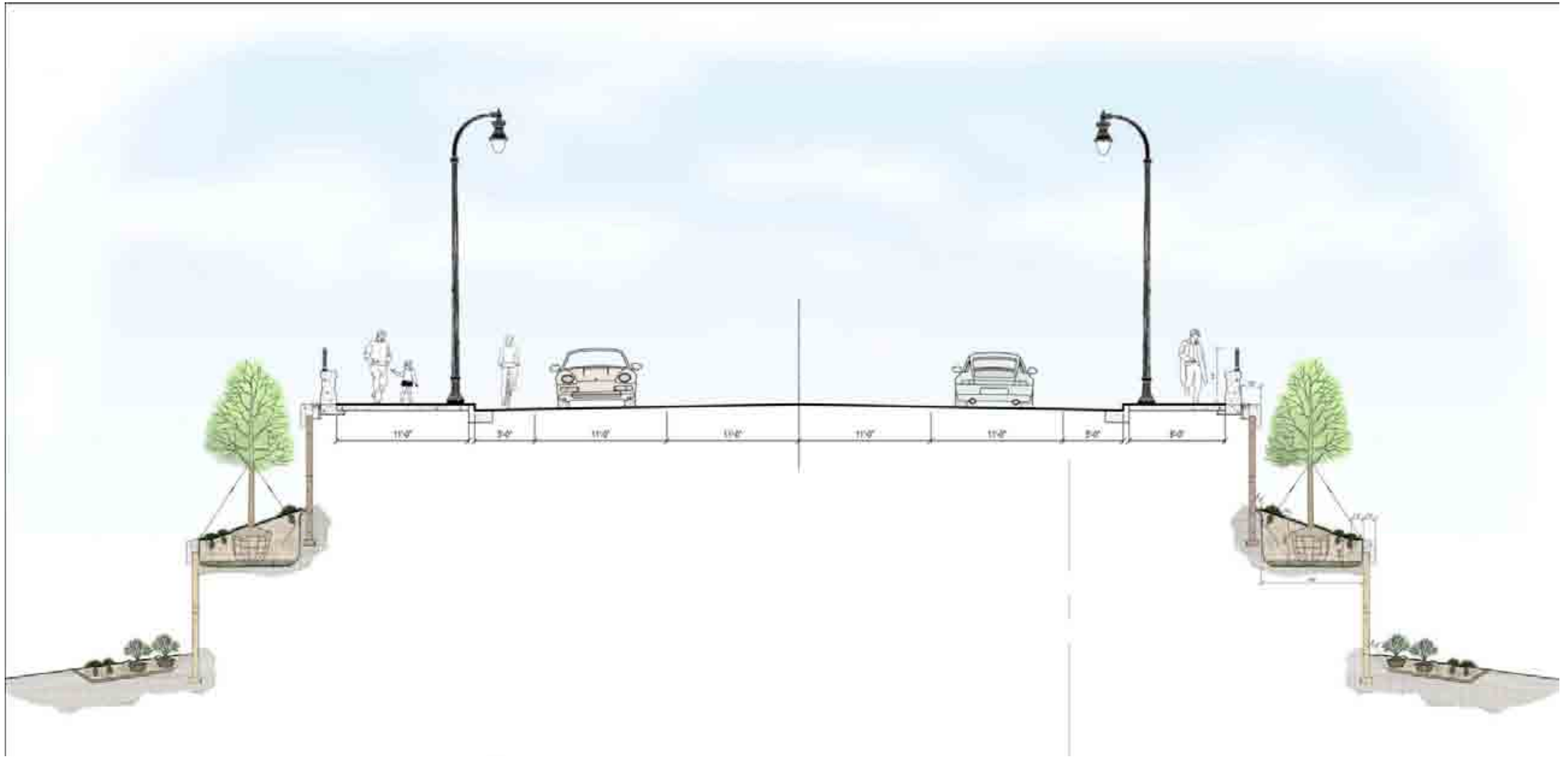
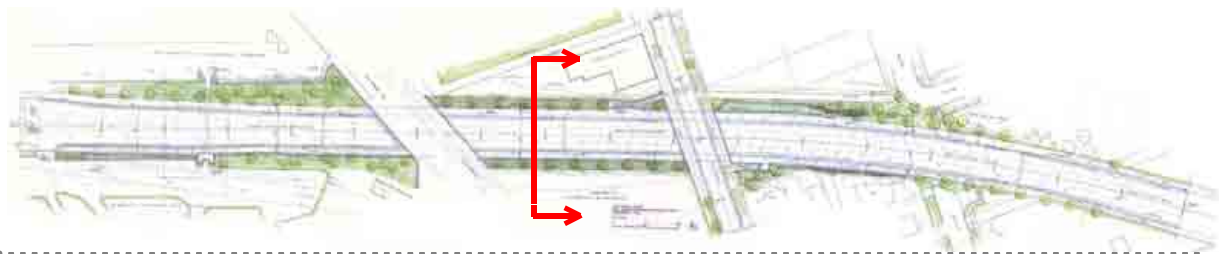

East Stadium Bridges Replacement

final design

design options

- Railings/barriers

- Retaining walls

- Texture
- Colors
- Surface patterns

- Lighting

- Stairways

- Rose Avenue/
White Street

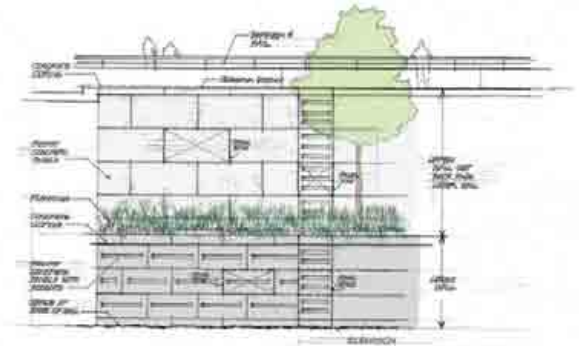
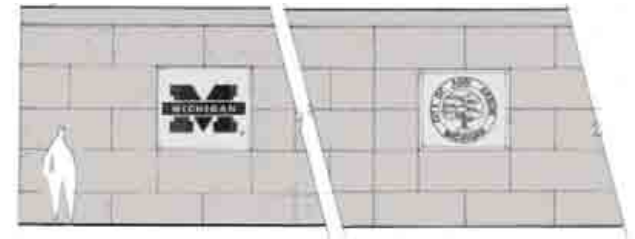
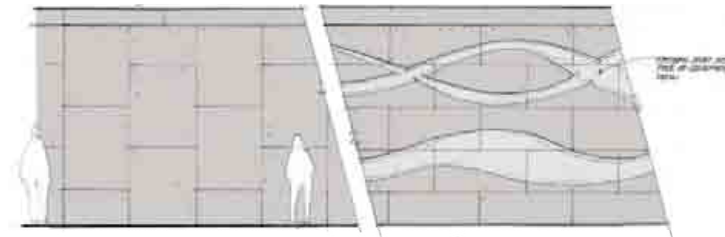
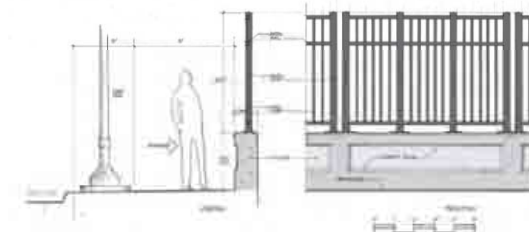
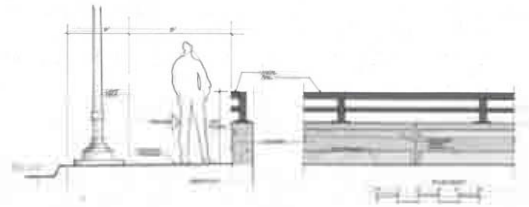
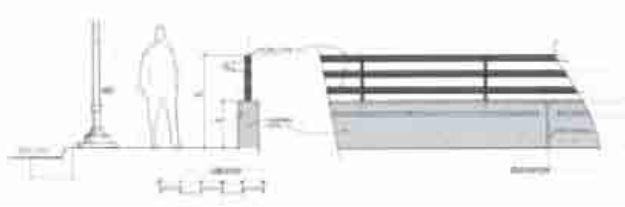
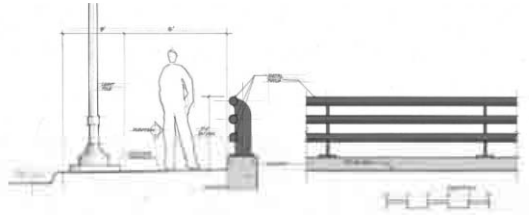

East Stadium Bridges Replacement

design options – railings/barriers

design options – railings/barriers

Design Choices

- Concrete Curb vs. Concrete Wall
- Rail Design
- Rail Color/Finish
 - Galvanized Steel (Matte)
 - Painted
 - Other, e.g. Stainless Steel
- Wall Scoring/Reveals
- Overall Height (42" min vs. 54")

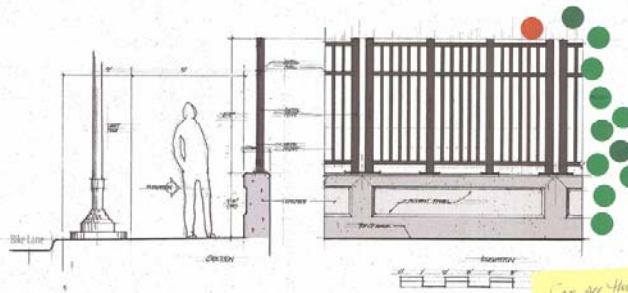
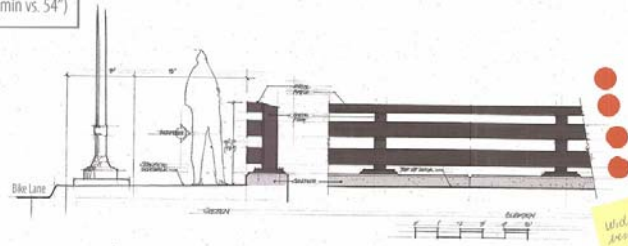

Can we make this fence higher and being a lower curb wall?

Too tall. With the 4 ft 4 in. shadow.

Half the height but keep head cut.

design options – railings/barriers

Design Choices

- Concrete Curb vs. Concrete Wall
- Rail Design
- Rail Color/Finish
 - Galvanized Steel (Matte)
 - Painted
 - Other, e.g. Stainless Steel
- Wall Scoring/Reveals
- Overall Height (42" min vs. 54")

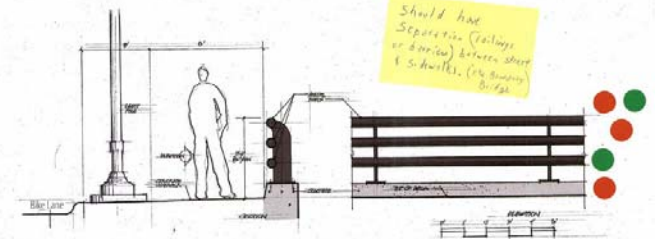

Can we get a view on barrier?

Let the look of strong the concrete up 4 ft 4 in. above the rail. (e.g. bridge railing)

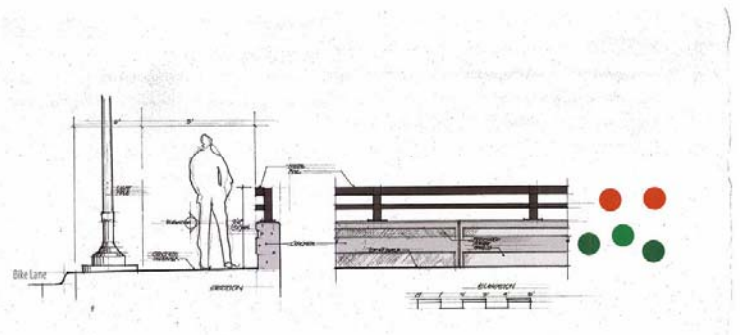
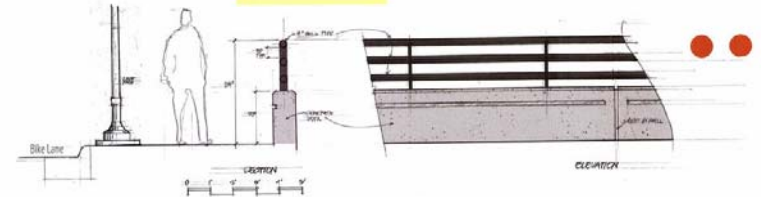

East Stadium Bridges Replacement

design direction – railings/barriers

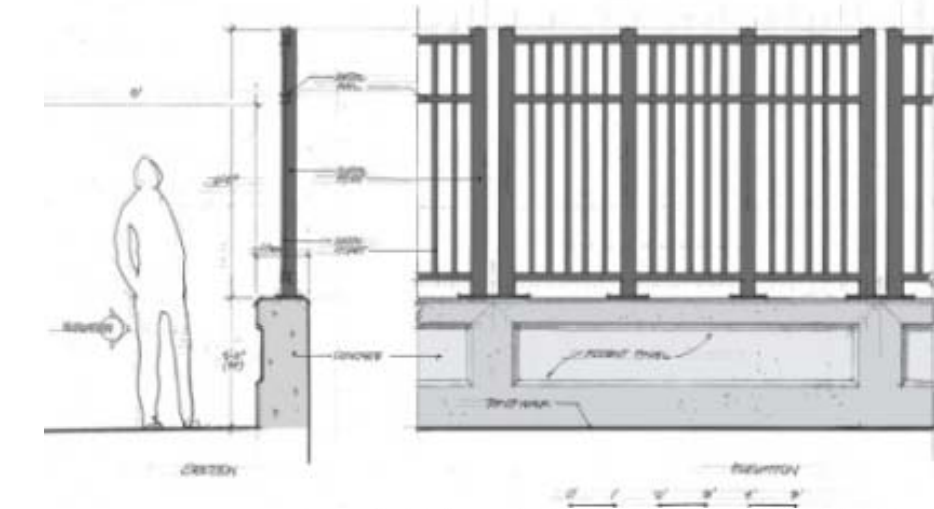

8'-10" tall

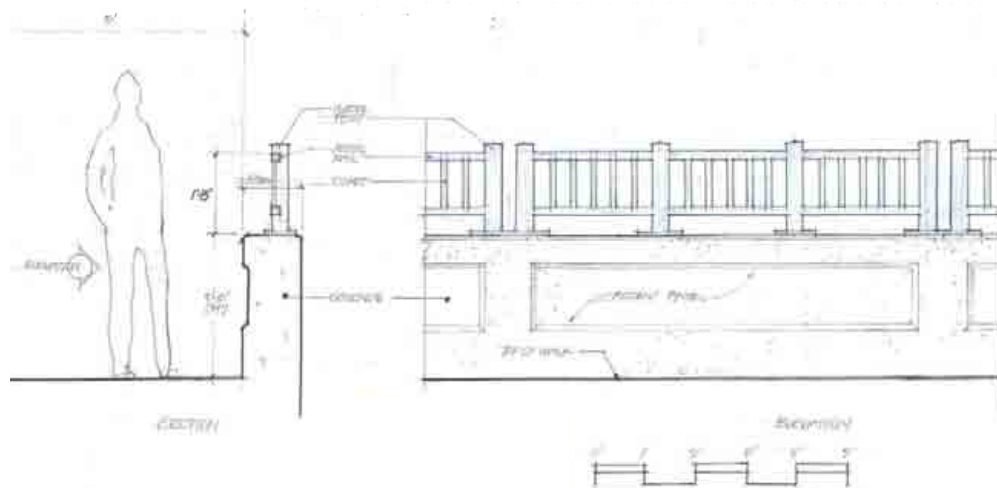

54" tall



final design – railings/barriers

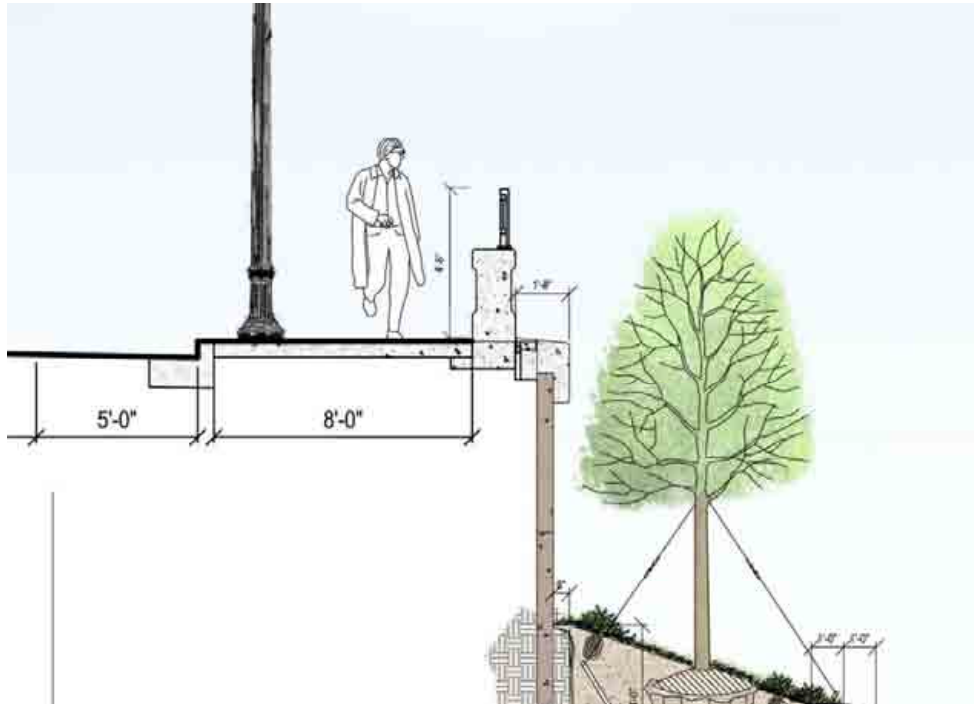

barrier and rail section

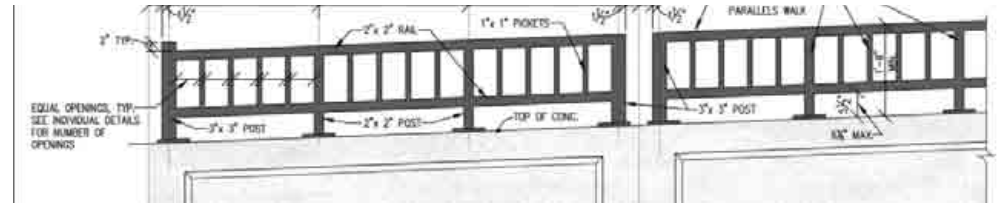

barrier and rail elevation



design options – lighting + stairways

design options – lighting

Design Choices

- Street Light
- Wall-Mounted Light Under Bridge
- Lights Adjacent to Bridge

Are Solar Lights Possible?

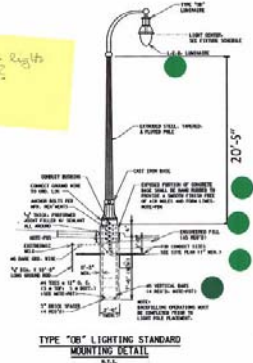

West Stadium Boulevard Light - Pauline Boulevard to 7th Street

Street Light



Street Light Based on West Stadium Boulevard Light

UNDER BRIDGE Stair Lights



Wall-Mounted Stair Light



Stair Light Above Column

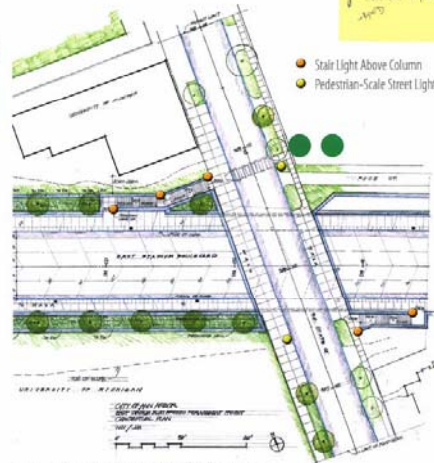

Proposed Light Locations at South State Street

design options – stairways

Design Choices

- Solid Parapet with Inside Handrail
- Lights Above Parapet Wall with Column Definition
- Open Railing Above Parapet
- Wall-Mounted Lights

Stairways

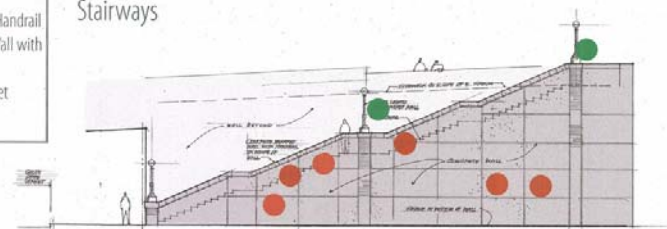

Solid Parapet Wall with Inside Handrail
Lights Above Parapet Wall with Column Definition

like open rail w/ raised light (above rail)



Please put in bike path. They are needed before ramps can work better than street.

Stairways aren't needed

Don't need street bike path

Open rail better for narrow + narrow removal

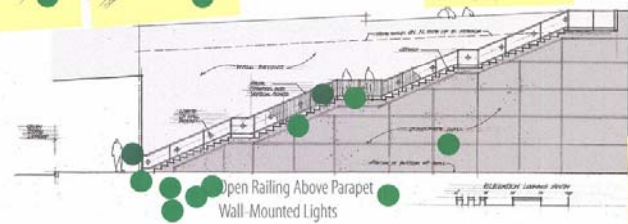

Open Railing Above Parapet
Wall-Mounted Lights

Need stairways and street bike paths on both sides

Make the bridge a full bridge

Railings



Inside Handrail



Open Railing



East Stadium Bridges Replacement

design direction – lighting + stairways

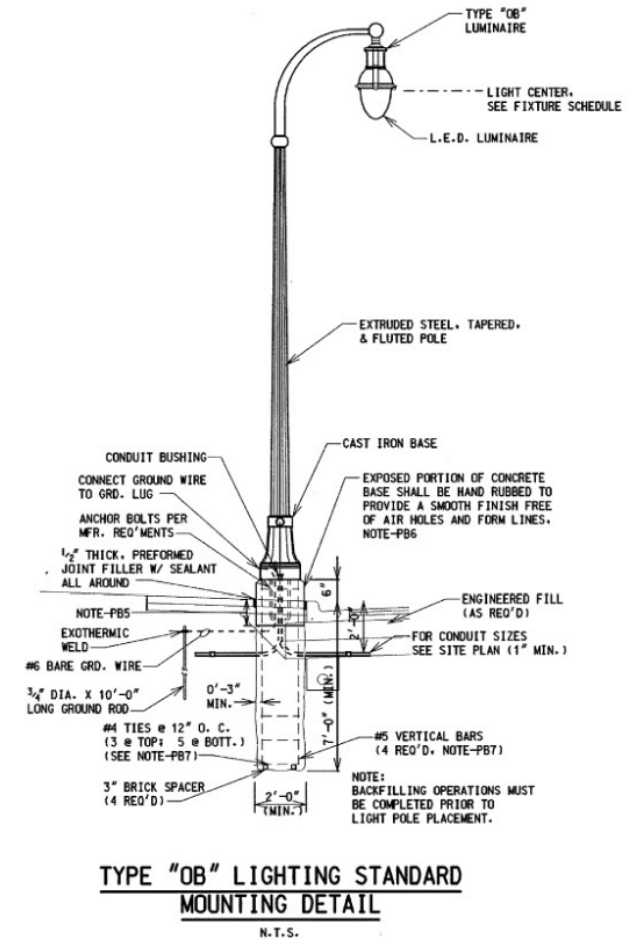
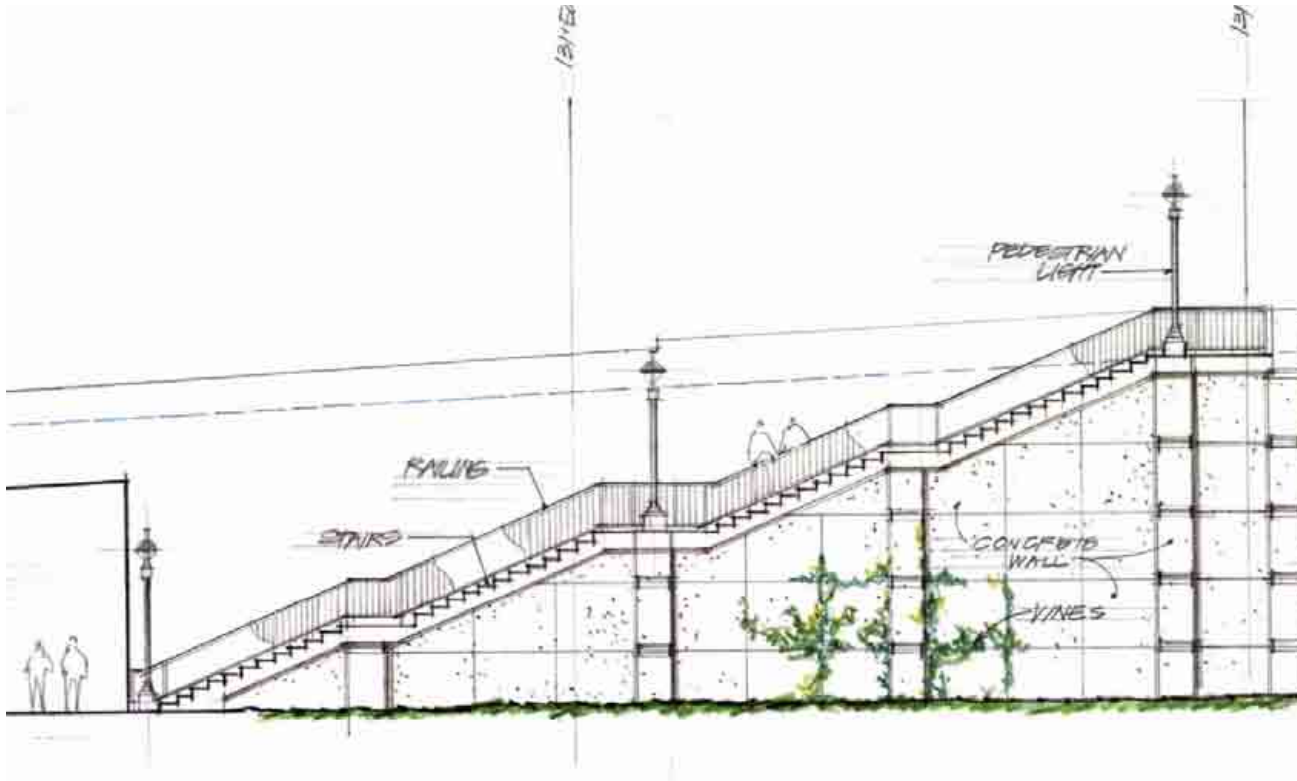

East Stadium Bridges Replacement

final design – lighting + stairways

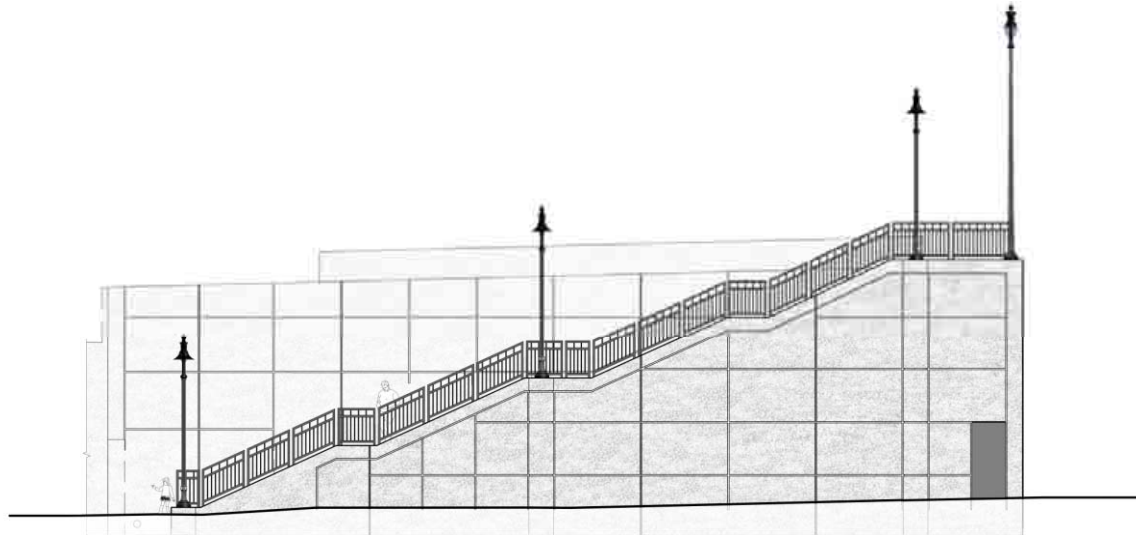

northeast stair elevation

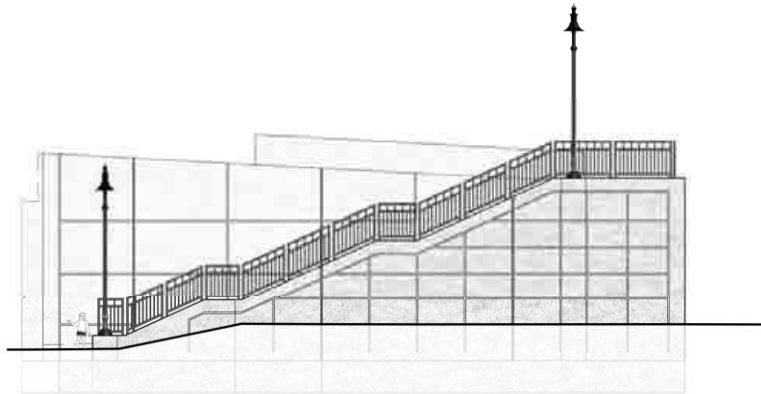

southwest stair elevation



street light elevation



pedestrian light elevation



design options - retaining walls

Design directions

- texture and color
 - ✓ not “fake”
- patterning
 - ✓ Different patterns on upper and lower walls
- logos – no UM logo
- planting to soften – yes!

design options - walls

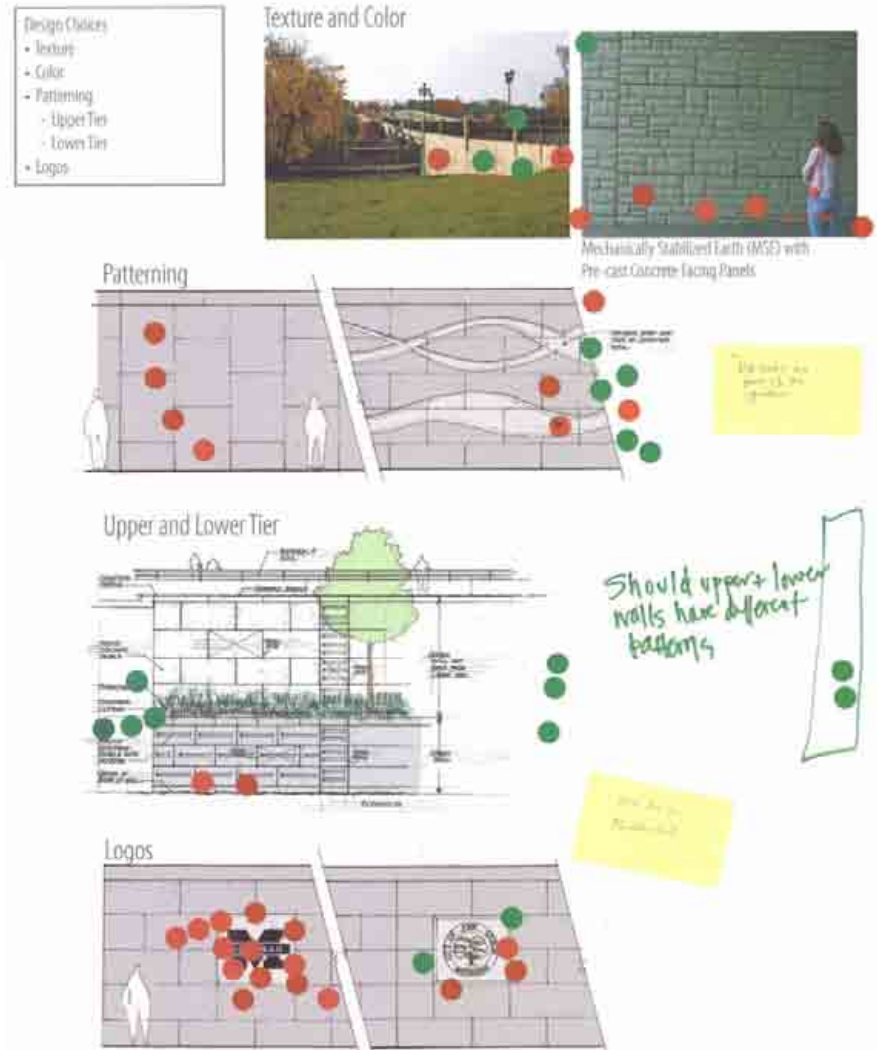

retaining wall options

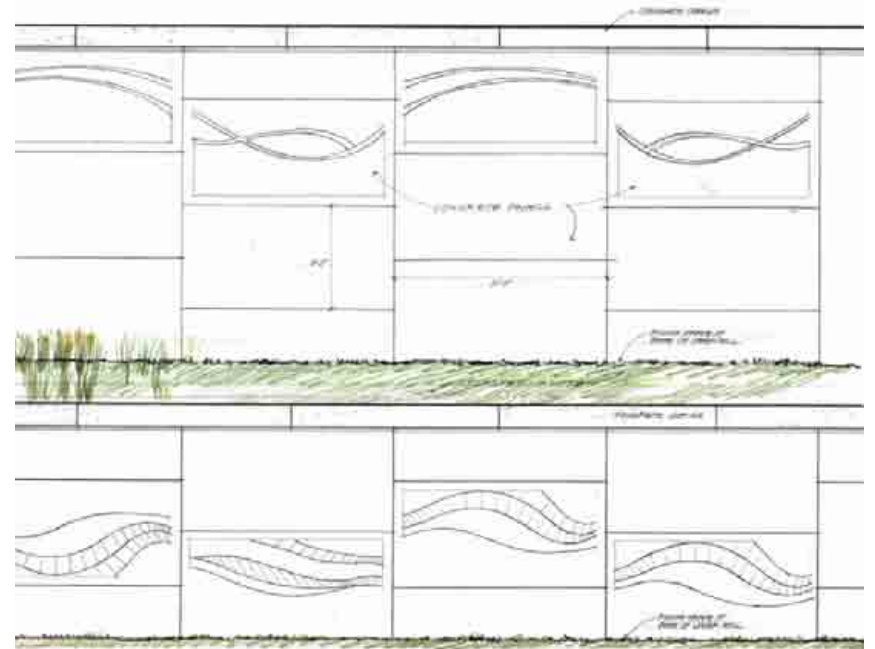
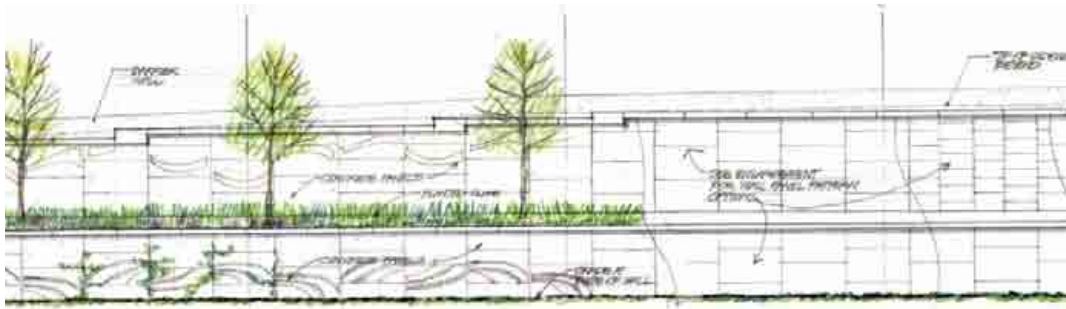

East Stadium Bridges Replacement

UM Parking lot (north side)



East Stadium Bridges Replacement

existing

UM Parking lot (north side)

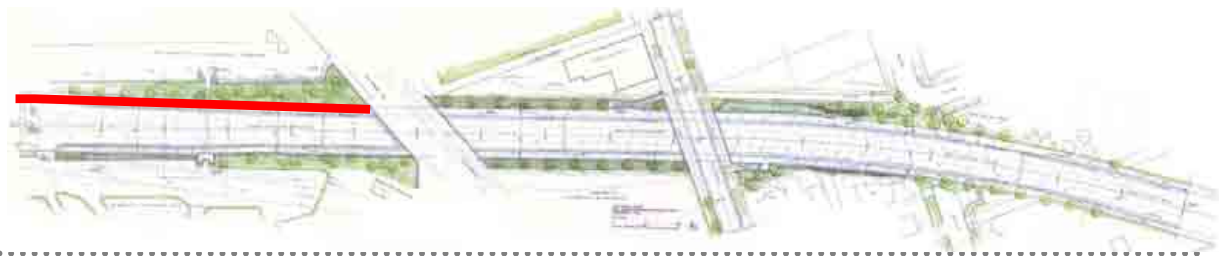

"granite" color



modular retaining wall



UM to AARR

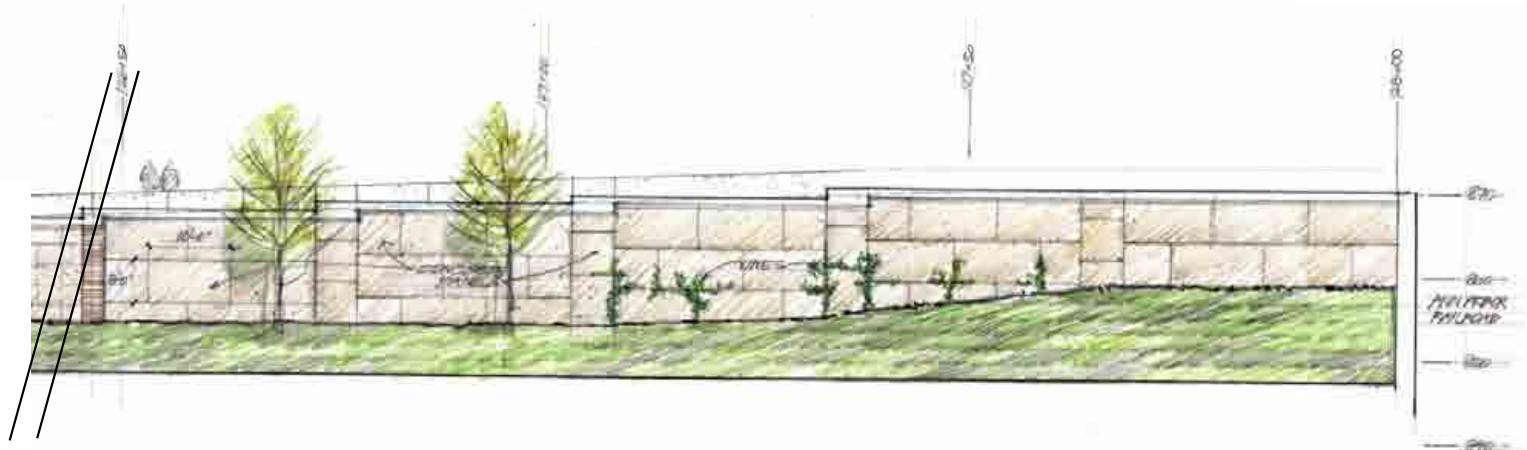
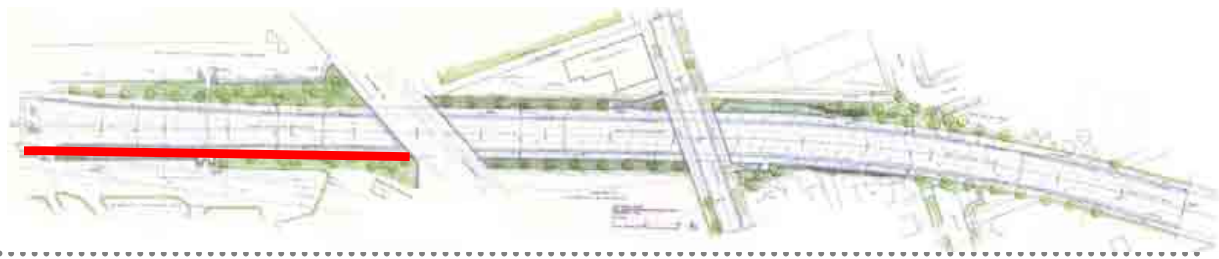

ELEVATION LOOKING NORTH



East Stadium Bridges Replacement

design direction

UM to AARR

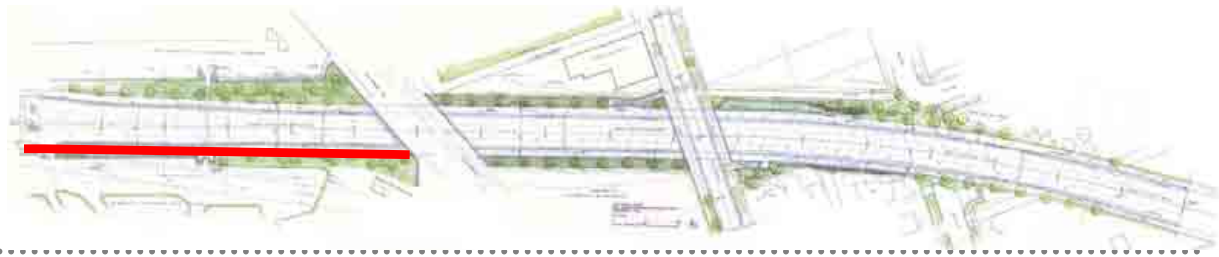

wall elevation at u-m

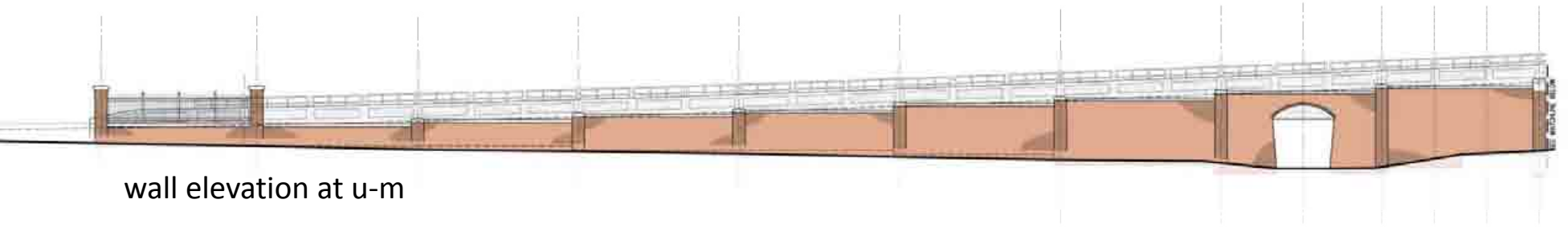

wall elevation at ann arbor rail road

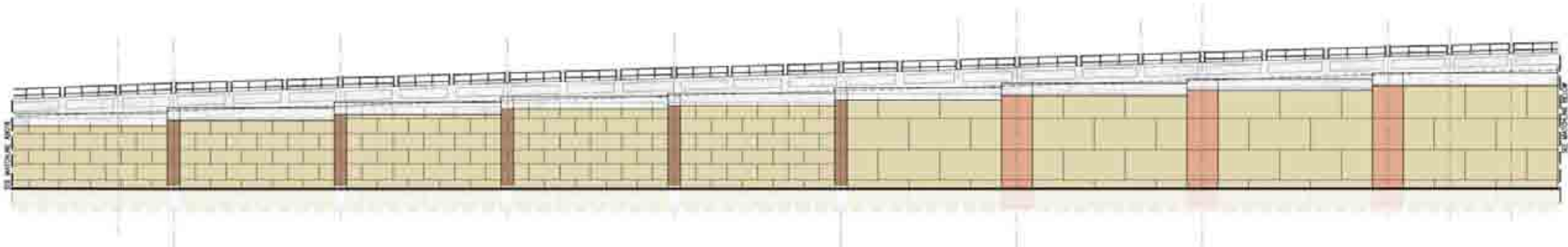

East Stadium Bridges Replacement

final design

Rose Avenue

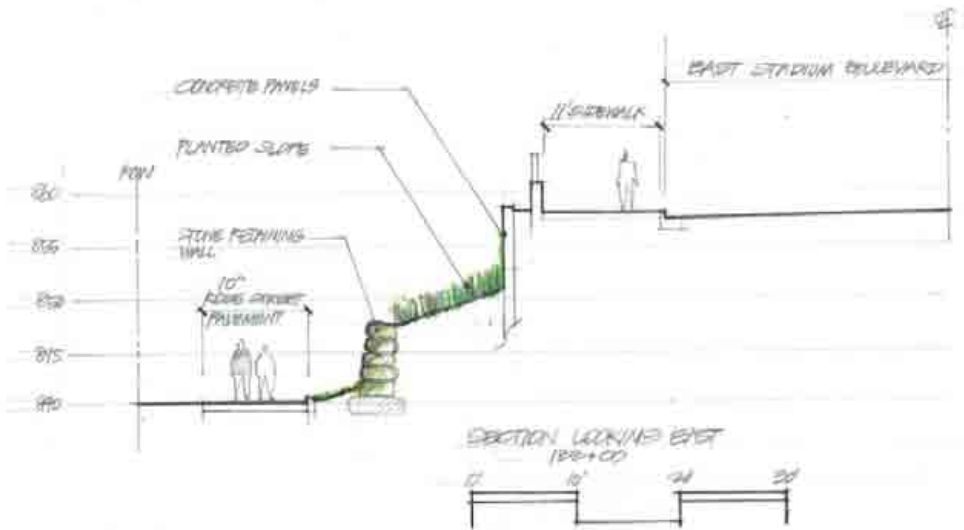
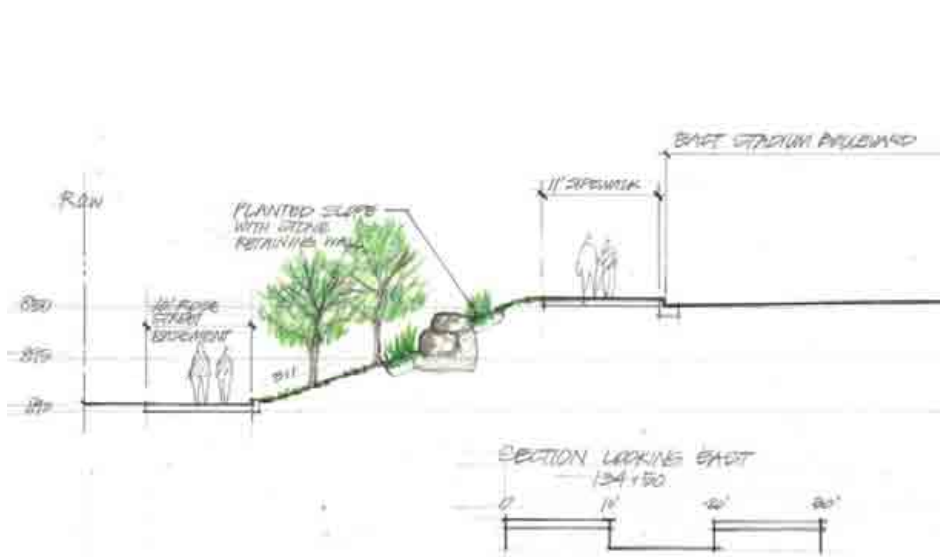
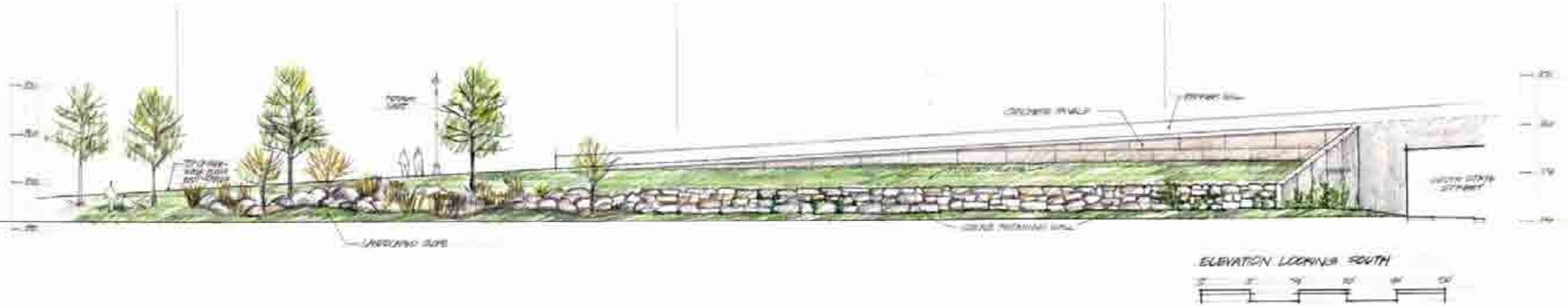

East Stadium Bridges Replacement

design direction

Rose Avenue

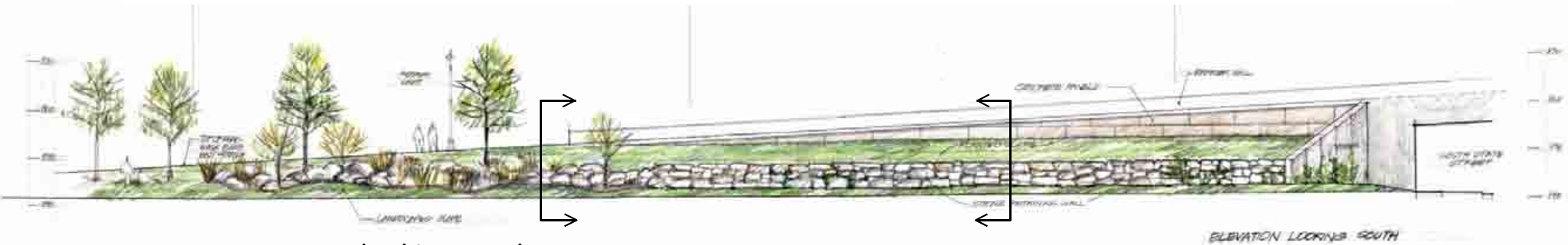
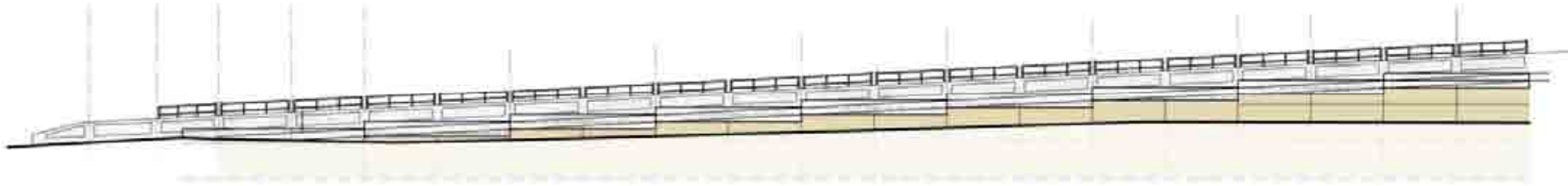

Rose avenue looking south

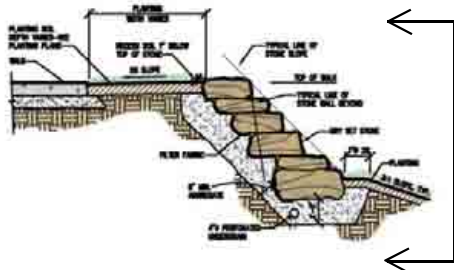

rock wall section

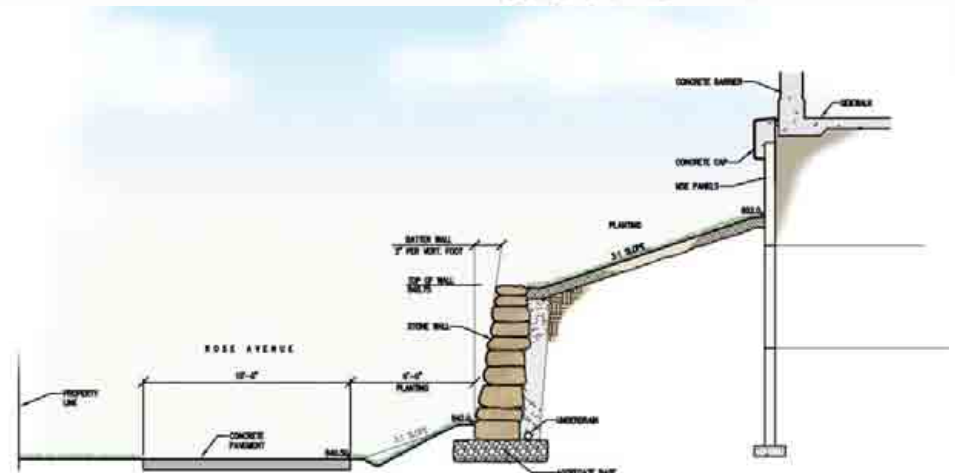
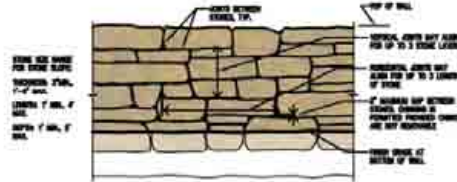

rock and mse panel wall section



East Stadium Bridges Replacement

final design

Rose Avenue

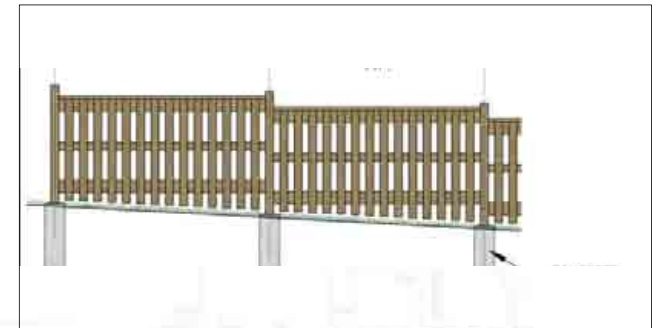
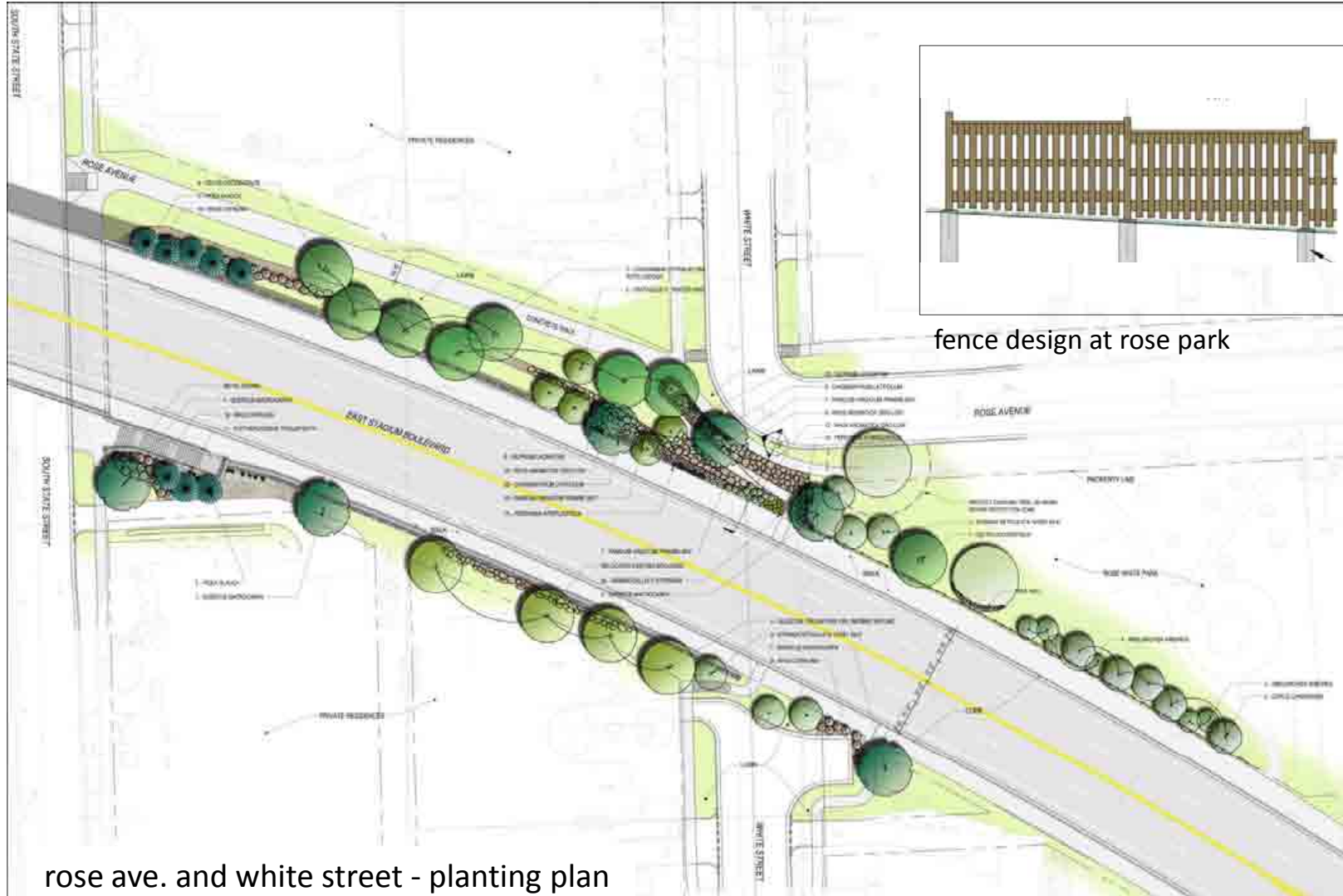

fence design at rose park



East Stadium Bridges Replacement

final design

other walls

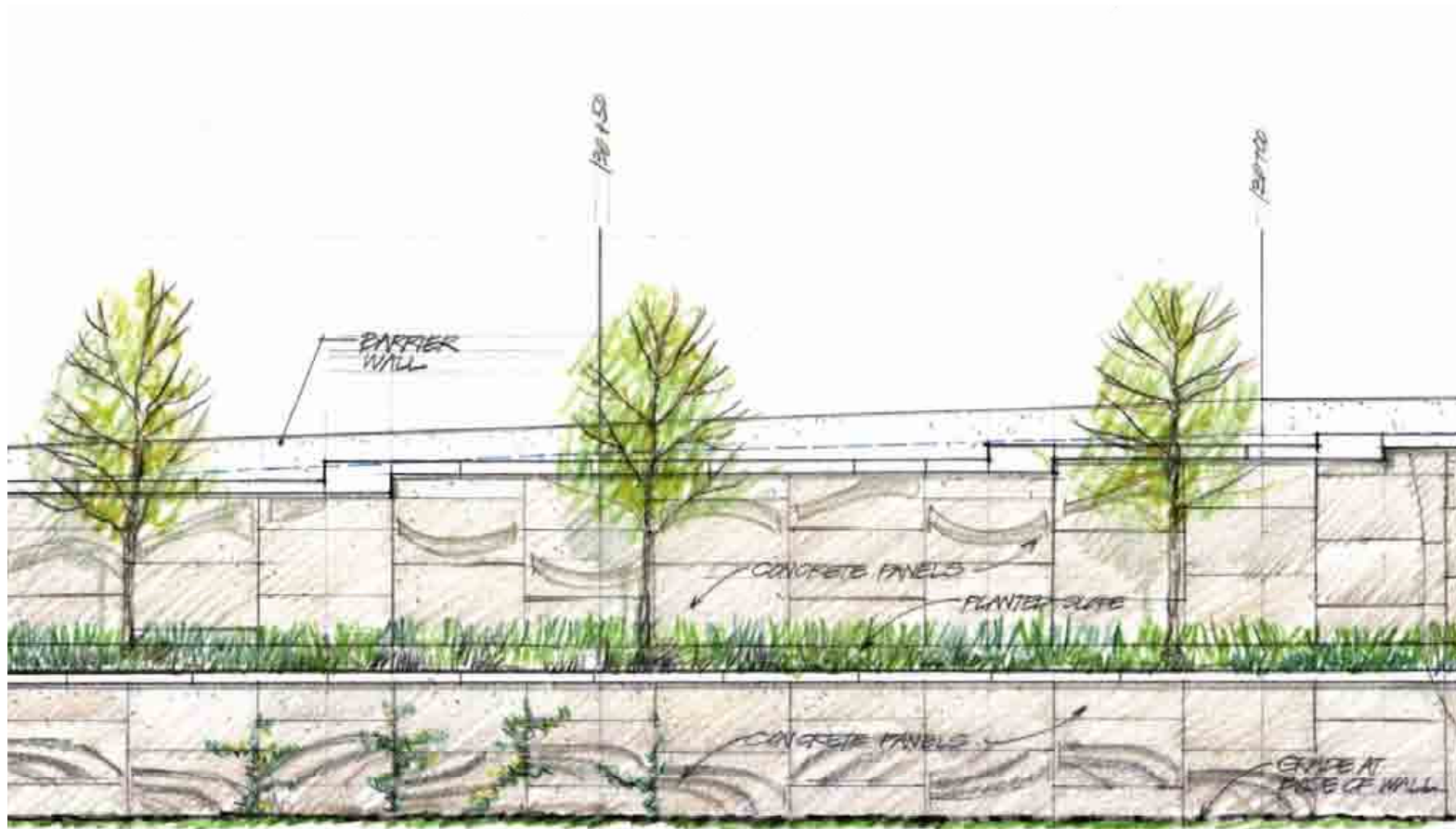

East Stadium Bridges Replacement

design direction

other walls

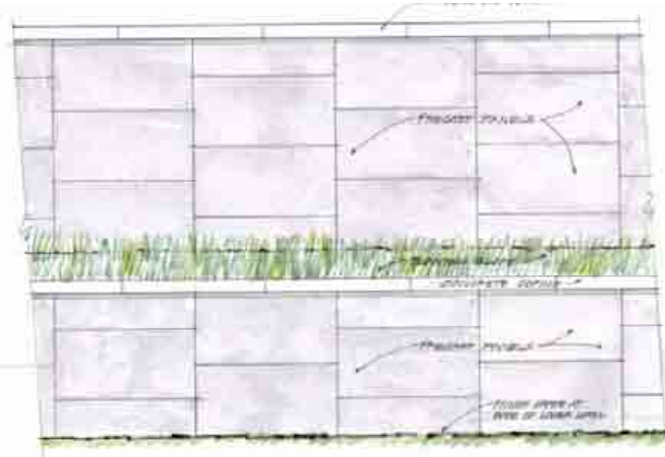
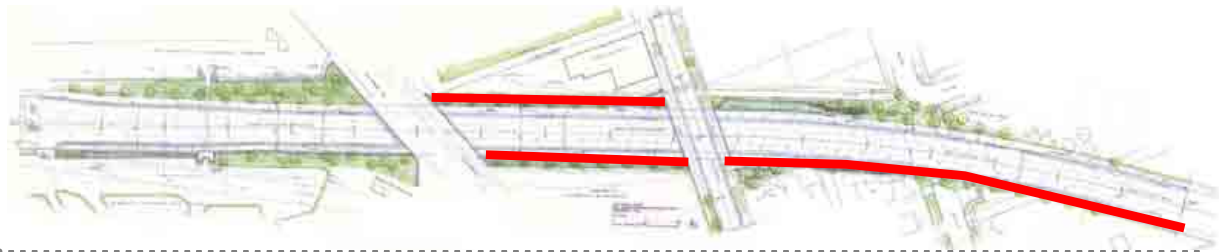

OPTION A
Plain Wall

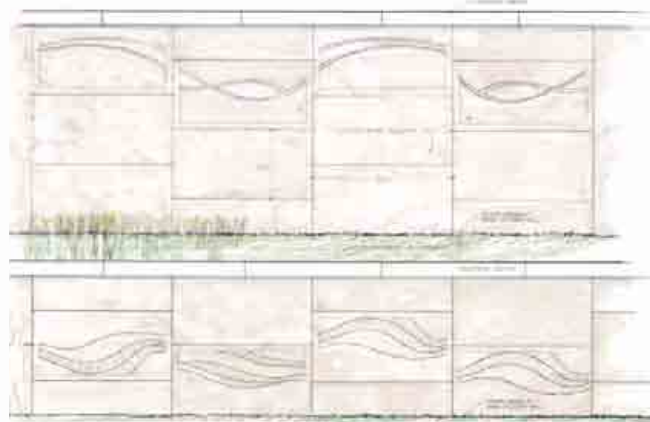

OPTION B
Earth + Sky

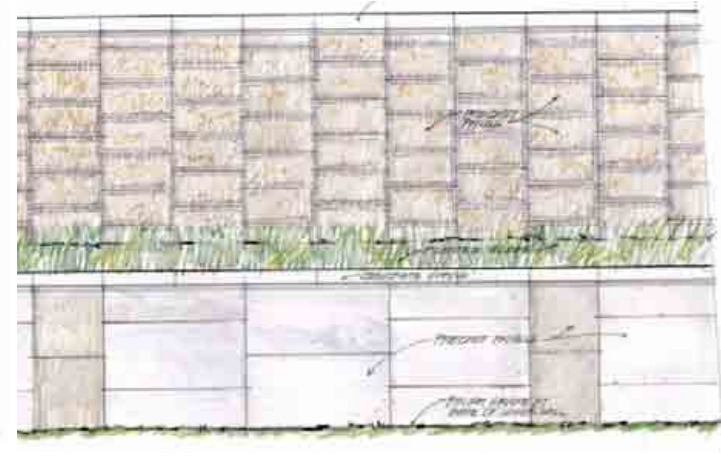

OPTION C
Smooth + Rusticated

your choice



other walls

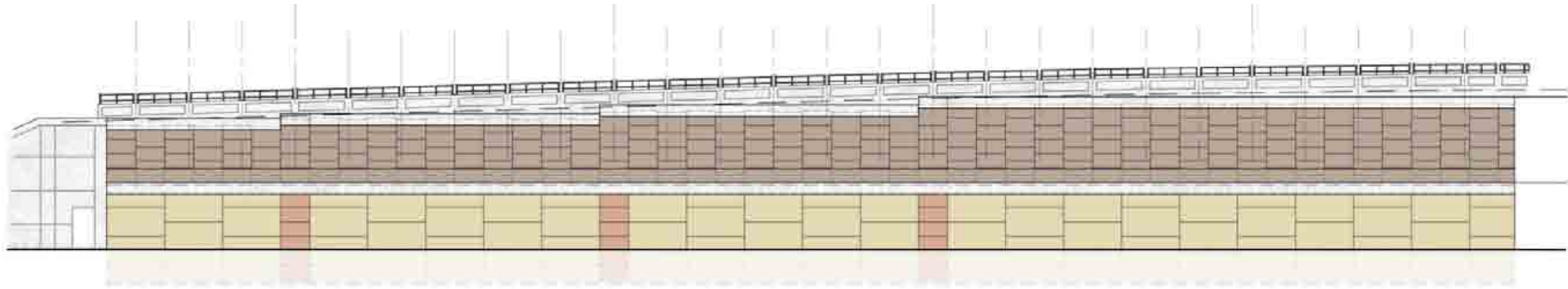
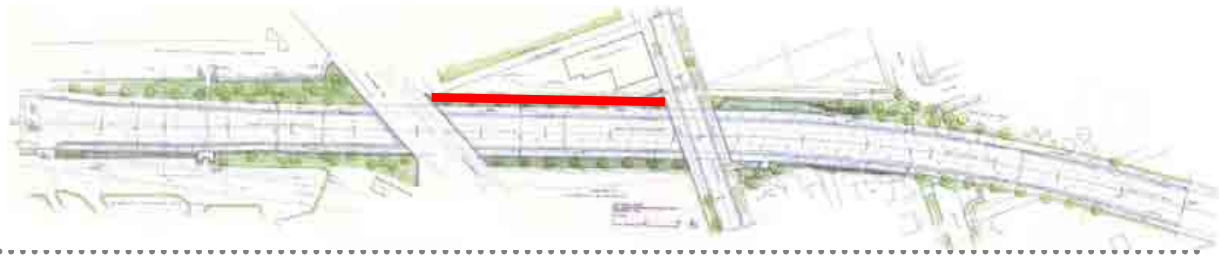

mse wall elevation – between AARR and state street

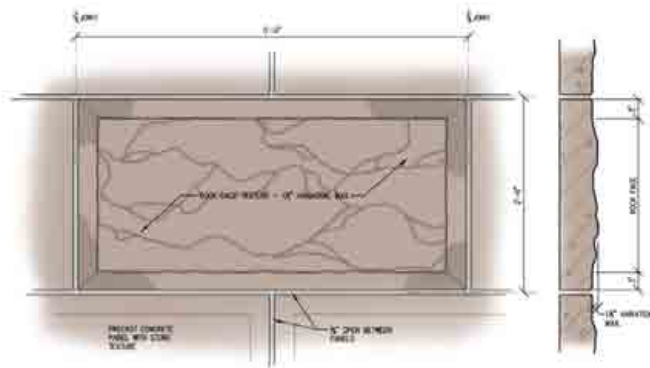

elevation and section of rusticated panel



other walls

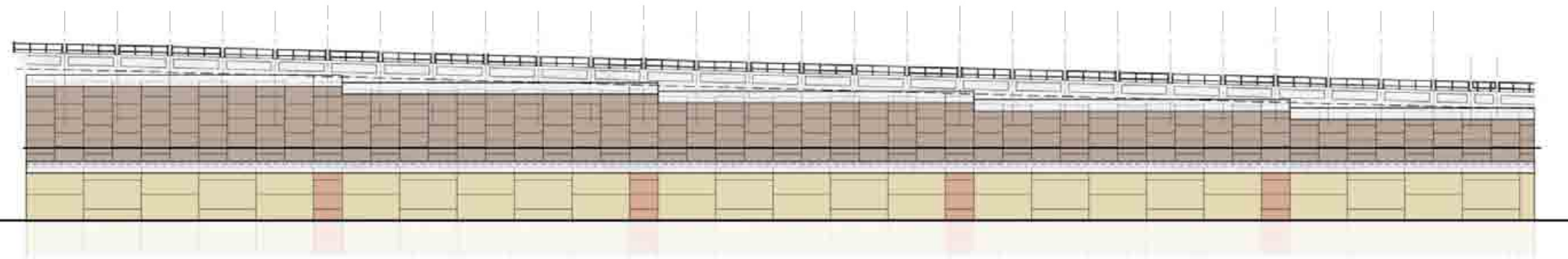

mse wall elevation – between state street and white street



mse wall elevation – between white street and henry street



funding – project cost

\$23,000,000

- Design
- Right-of-Way
- Construction Engineering
- Construction



funding – sources

	Total	%
Funding Source		
TIGER II Discretionary Grant Funds	\$13,900	
Transportation Enhancement Funds - FY 11	\$1,202	
MDOT Local Bridge Program Funds - FY 13 (Advance Construct) *	\$1,670	
State and Federal Subtotal	\$16,772	73%
City of Ann Arbor Funds	\$6,228	27%
TOTAL	\$23,000	

NOTES:

All values are represented in thousands of dollars

* Advance Construct funds - the City will interim fund the work and be reimbursed.



overall project schedule

Stadium Boulevard Bridges Project Schedule

March 23rd, 2011

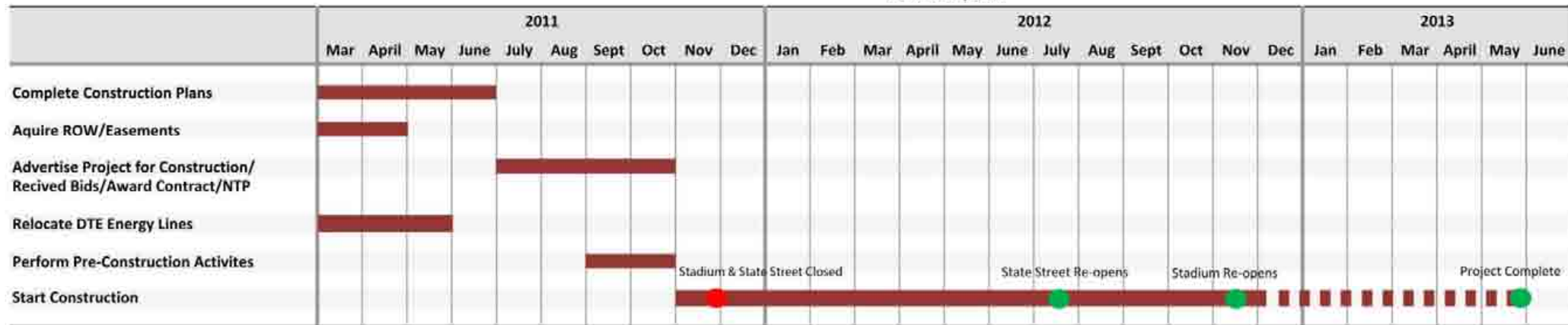

East Stadium Bridges Replacement

major construction milestones

- Notice to Proceed issued to contractor: on or about 10/03/2011
- Close Stadium Blvd. and detour traffic: 11/28/2011
- Close State St. and detour traffic: 11/28/2011
- Re-open State St. to 2-way traffic with construction zones: 12/13/2011
- Detour NB State St./Maintain SB State St. with construction zone: 5/3/2012
- Re-open State St. to full traffic: 7/11/2012
- Re-open Stadium Blvd. to full traffic: 11/14/2012
- Project Complete: 5/30/2013





- # East Stadium Bridges Replacement



construction detours

- **South State Street closed entirely between 11/28/2011 to 12/13/2011**
- **State Street re-opens to 2-way traffic 12/13/11 to 05/03/2012**
- **Detour north bound State St. and maintain south bound traffic 05/03/2012 – 07/11/2012**
- **South State maybe closed for short periods**

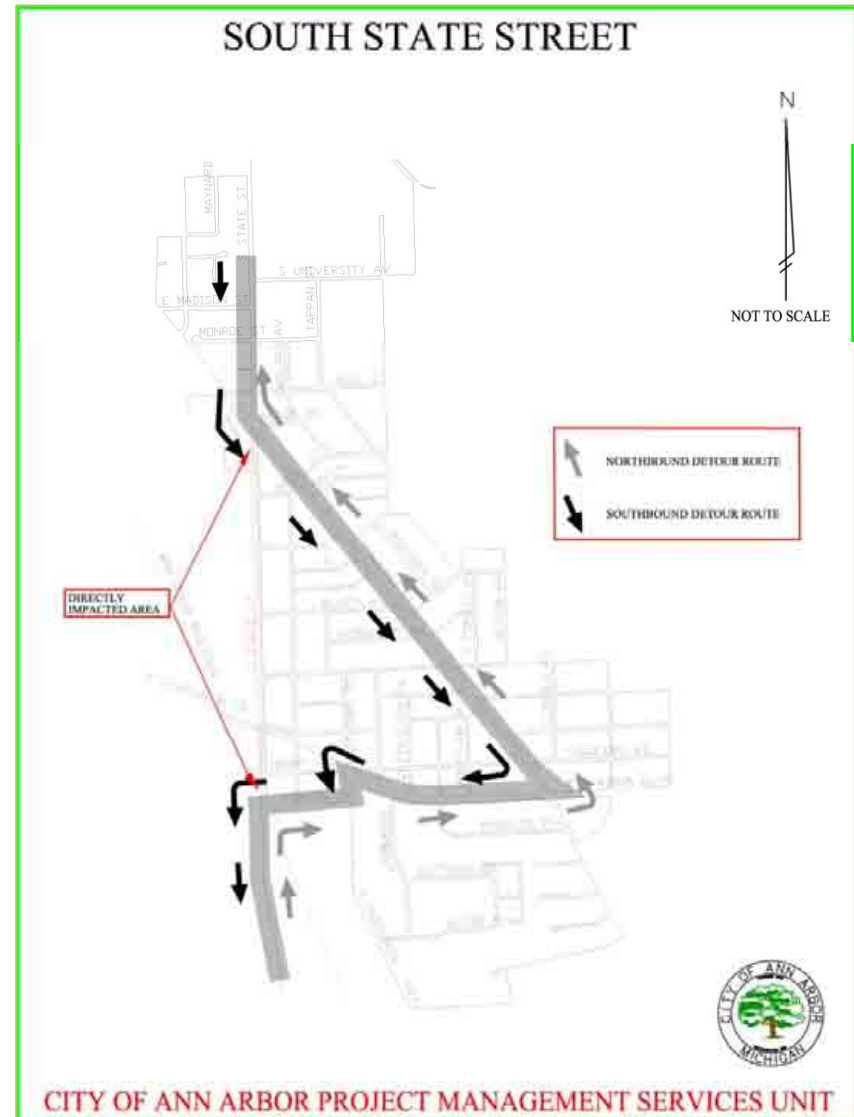

staying in touch

[a2gov.org/stadium bridges](http://a2gov.org/stadium_bridges) e-mail updates

- staff contacts

hpirooz@a2gov.org

mnearing@a2gov.org

